



## Industrial strength in capturing:

- WELDING FUMES
- GRINDING DUSTS
- DRY DUSTS
- SOLDERING FUMES
- POWDERS
- PLASMA CUTTING

## Industrial Strength Fume Arms



- 1 HOOD JOINT**  
Hood easily positions forward, backward and sideways.  
All external adjustments.  
Flexible hose with gear clamps.
- 2 MIDDLE JOINT**  
All external adjustments.  
Flexible hose with gear clamps.
- 3 SOCKET JOINT**  
Rotating swivel with safety stop, for 180° rotation. All external adjustments. Flexible hose with gear clamps.

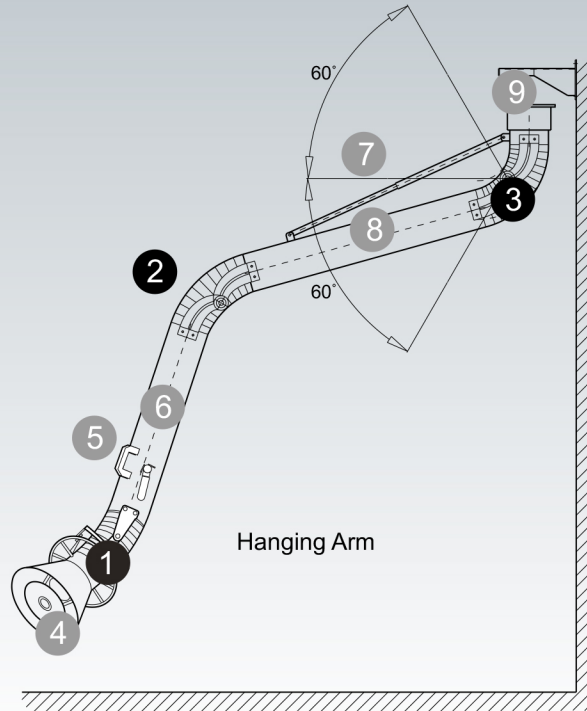
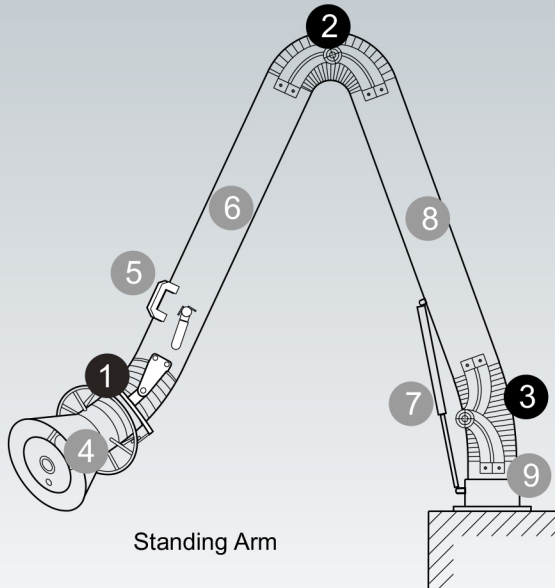

- 4** Aluminium hood (powder coated) with surrounding grab handle.
- 5** Additional tube grab handle.
- 6** Smooth steel tube (powder coated) with standard damper.
- 7** Support spring or gas shock on the outside on both versions.
- 8** Smooth steel tube (powder coated).
- 9** Swivel base with predrilled mounting holes, 350° rotation.

## Comparison

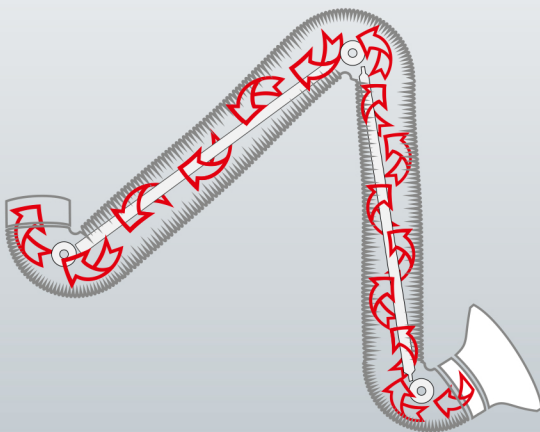

### Other Brands - Internal Components

- restricted airflow
- higher static pressure
- hard to clean
- build up on joint and components

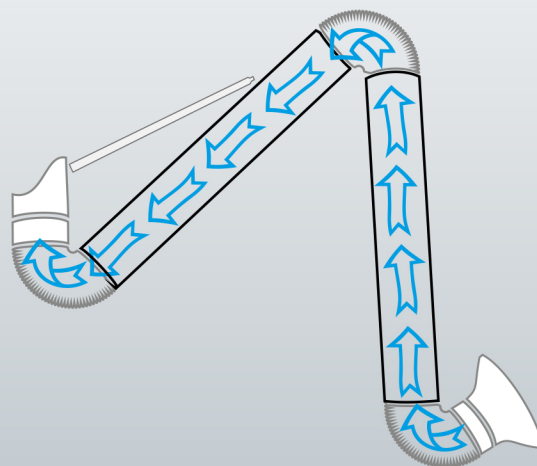

### IAP Fume Arm - External Components

- unrestricted airflow
- lower static pressure
- quick cleaning
- minimal build up



## Applications:

- Welding · Grinding · Polishing · Cutting
- Soldering · Chemical Fumes and many more!

## Features:

- Industrial strength
- Versatile design
- Smooth tube construction
- External joints and supports
- Hood and tube grab handles
- Air diverter in the hood
- Standard damper

## Accessories:

- Long lasting life time
- User-friendly operation
- Higher airflow performance
- Easy to adjust and maintain
- Simple positioning
- Increased capture velocity
- Damper and mounting bracket included

## Standard Hanging Mount Brackets

Bracket type Ø [inches]	n	ØD [inches]	C [inches]	L [inches]	B [inches]	W [inches]	H [inches]	Weight [lb]
3	4	3.0	4.8	8.0	1.0	7.3	5.2	4.2
4	4	4.0	4.9	8.5	1.4	7.9	5.7	4.8
5	6	5.0	5.7	9.9	1.5	9.4	6.5	6.8
6	6	6.0	9.8	14.5	1.3	10.0	6.5	7.9
8	8	8.0	9.8	15.7	1.5	13.9	8.5	13.9

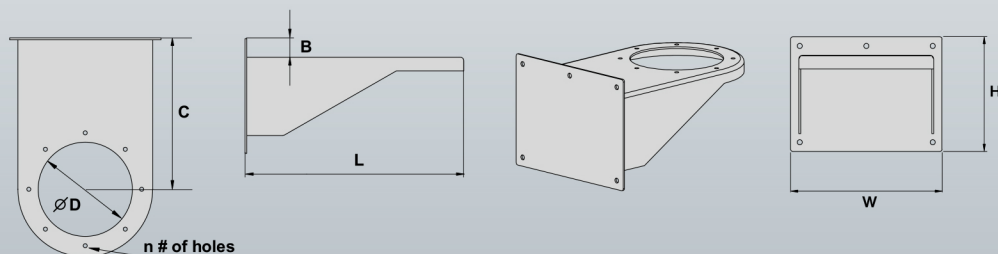



# Industrial Strength Fume Arms

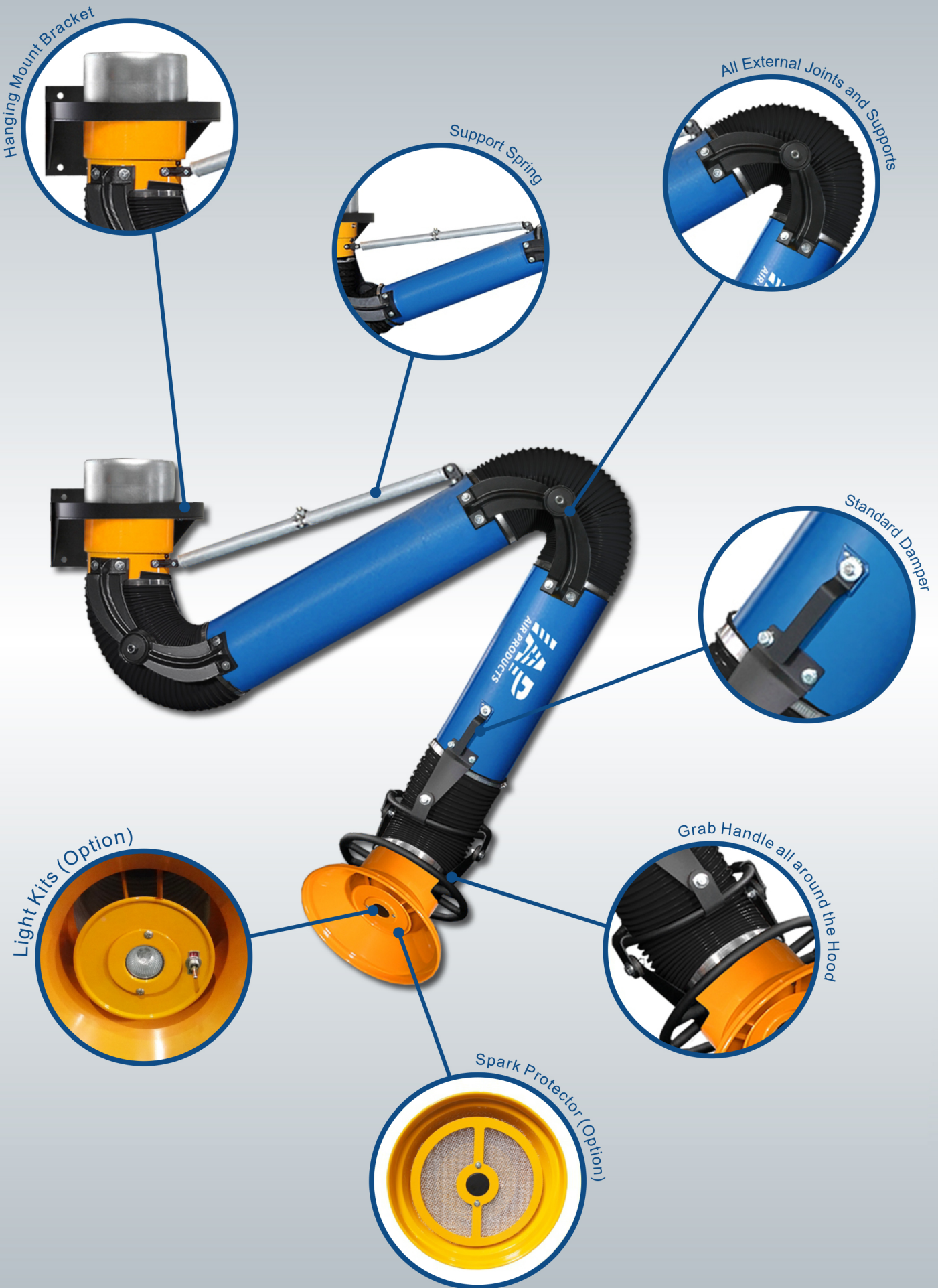



Technical Data

Arm Part #	Tube Diameter [inches]	Arm Length [Feet]	Hood Diameter [inches]	Ductwork Connection [inches]	Mounting Configuration	Typical Restrictions & Air Flow at 3000 fpm [inches wg]	Arm, Bracket and Hood Weight [lbs]
FA-0303	3	3	8	3	Hanging or Standing	1.2 @ 175 cfm	24.4
FA-0305	3	5	8	3	Hanging or Standing	1.2 @ 175 cfm	26.3
FA-0405	4	5	10	4	Hanging or Standing	1.1 @ 255 cfm	26.8
FA-0408	4	8	10	4	Hanging or Standing	1.1 @ 255 cfm	29.5
FA-0507	5	7	10	5	Hanging or Standing	1.0 @ 400 cfm	48.5
FA-0510	5	10	10	5	Hanging or Standing	1.0 @ 400 cfm	52.8
FA-0607	6	7	13	6	Hanging or Standing	0.8 @ 600 cfm	58.5
FA-0610	6	10	13	6	Hanging or Standing	0.8 @ 600 cfm	65.8
FA-0614	6	14	13	6	Hanging or Standing	0.8 @ 600 cfm	73.5
FA-0807	8	7	14	8	Hanging or Standing	0.7 @ 1050 cfm	84.7
FA-0810	8	10	14	8	Hanging or Standing	0.7 @ 1050 cfm	85.4
FA-0814	8	14	14	8	Hanging or Standing	0.7 @ 1050 cfm	99.2

\* All hanging arms include wall bracket and galvanized ductwork connection.  
\* If ordering Standing Arms, place a "P" behind part #.

EQUIPMENT OPTIONS			HOOD OPTIONS
Exhaust Fan	Floor Stanchions	Light Kits	20" diameter hoods for 6" arms
Ceiling Stanchions	Extension Booms	Wall Stanchions	20" diameter hoods for 8" arms



## Static Pressure & Airflow

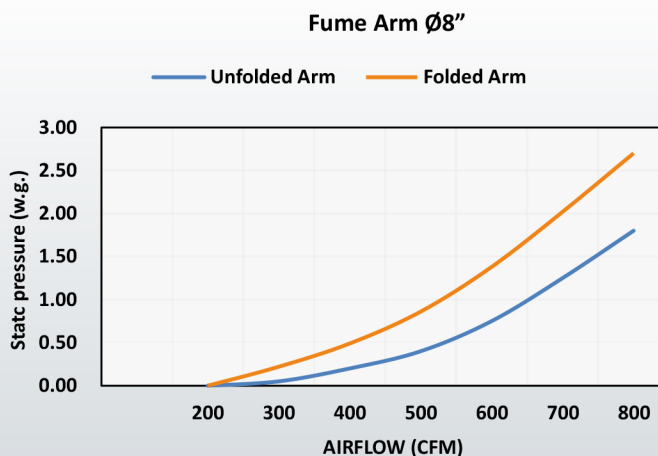
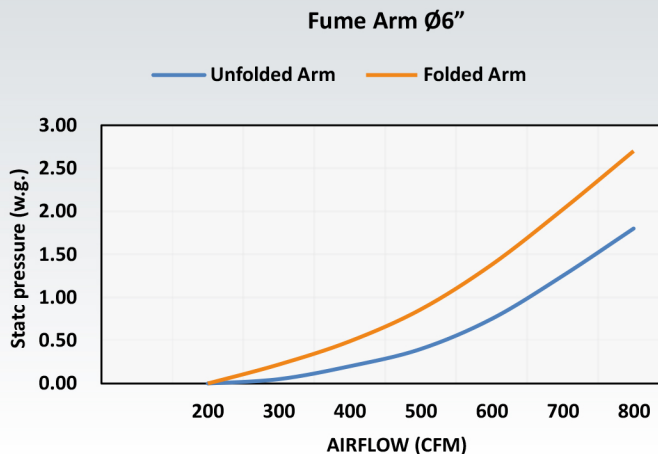
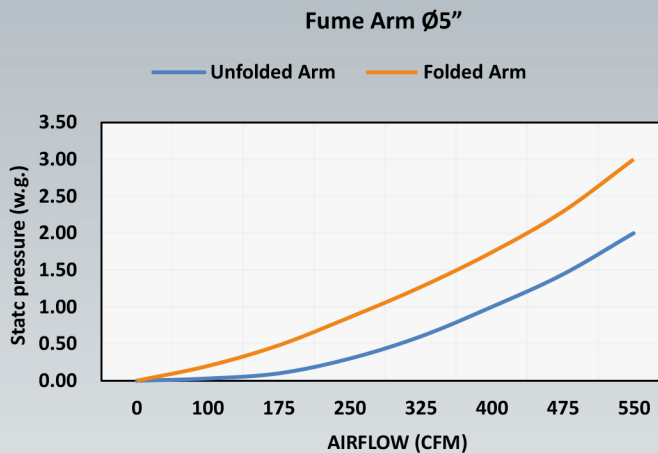
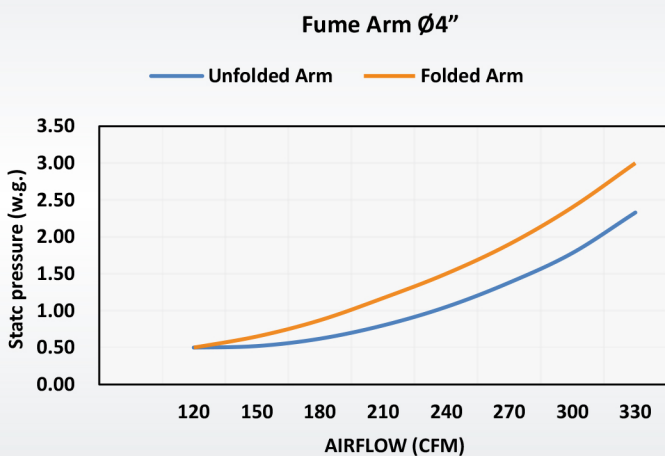
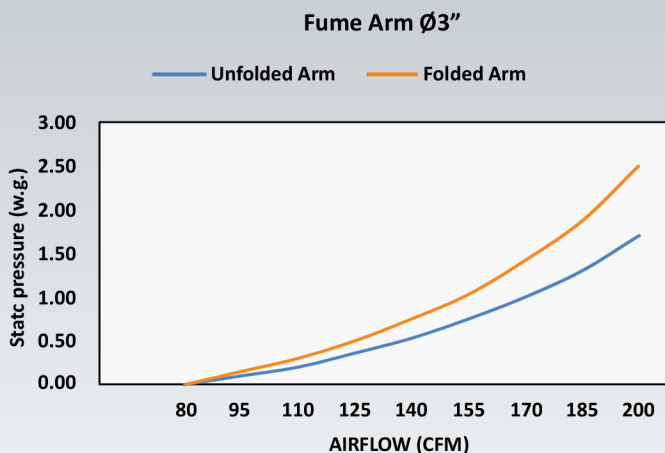

## Dealer Information / Contact:

**RLKUNZ**  
AIR SYSTEM PROS

**SINGLE SOURCE FOR**  
Fume / Welding / Dust Arms  
Ambient Air Cleaners, Mobile Welding Units  
Dust Collectors, Vehicle Exhaust, etc.  
<https://www.rlkunz.com>